

E+ PLUS

SMA Connectors & Hermetic Seals

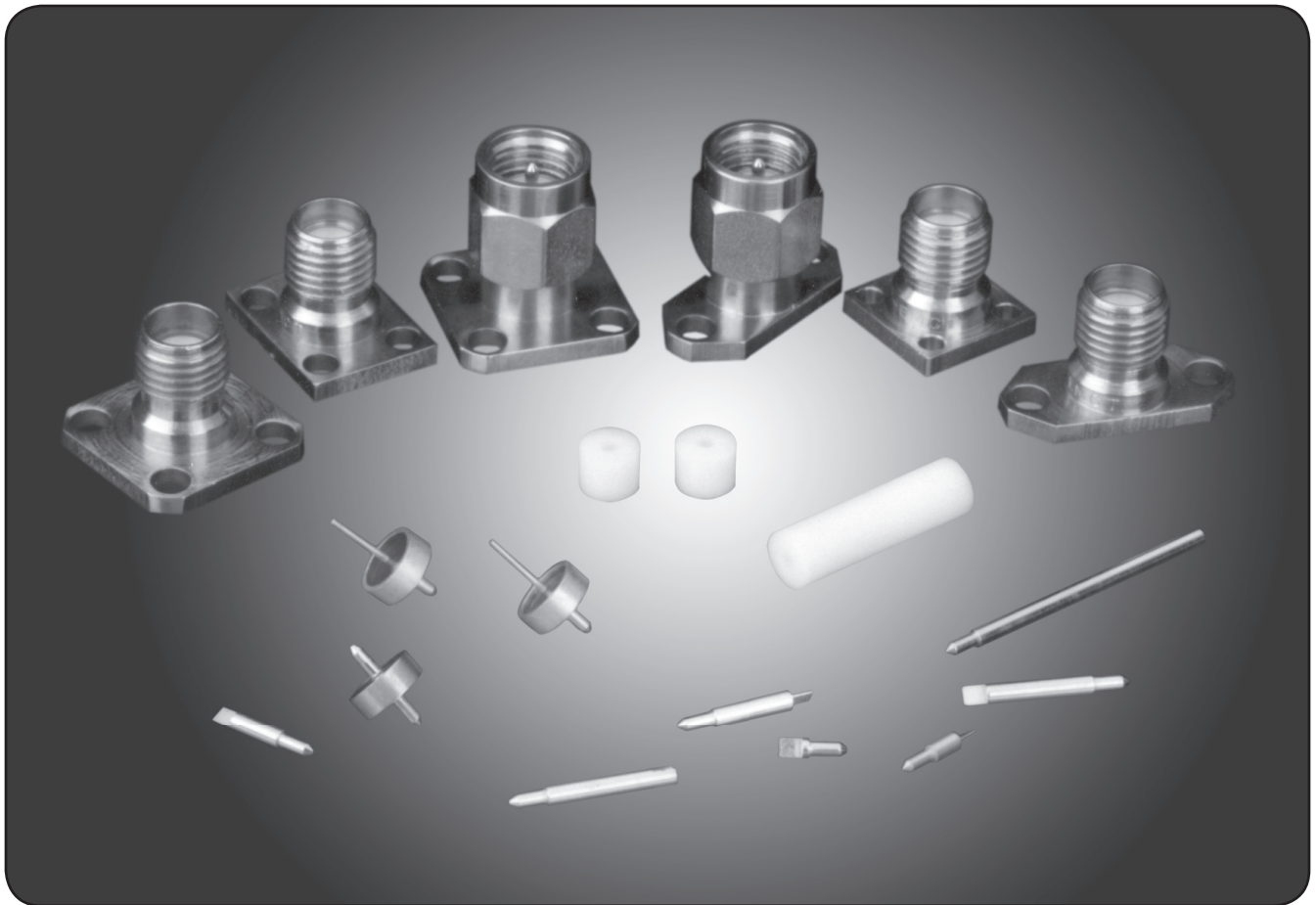

Micro  **Lambda, LLC**

Microwave, RF, and Hybrid Microelectronic Products

www.microlambda.com
info@microlambda.com

Micro Lambda North

9 Trenton-Lakewood Road • Clarksburg, NJ 08510
Phone: 609-259-0400 • Fax: 609-259-3005

Micro Lambda South

4513 Mountain Road • Pasadena, MD 21122
Phone: 410-437-7633 • Fax: 410-437-9786

Micro Lambda manufactures the E+ Plus Connector line to the demanding specifications originated by EMC Technology, Inc. Micro Lambda is in general compliance to MIL and Commercial Specifications, Standards, and Applications for SMA Connectors and Hermetic Seals.

General Specifications

Body: Stainless steel, passivated
 Center Contact: Beryllium copper, Gold plated (SMA Jack)
 Dielectric: PTFE
 Frequency Range: DC - 18 GHz
 VSWR: 1.05 + 0.005f (GHz)
 Nominal Impedance: 50 Ω

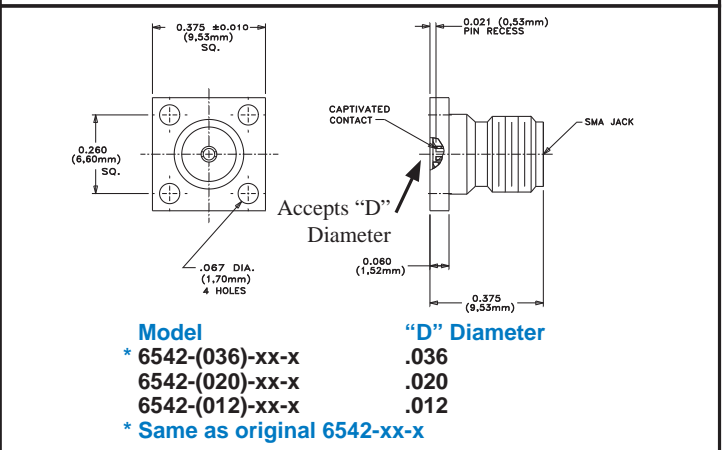
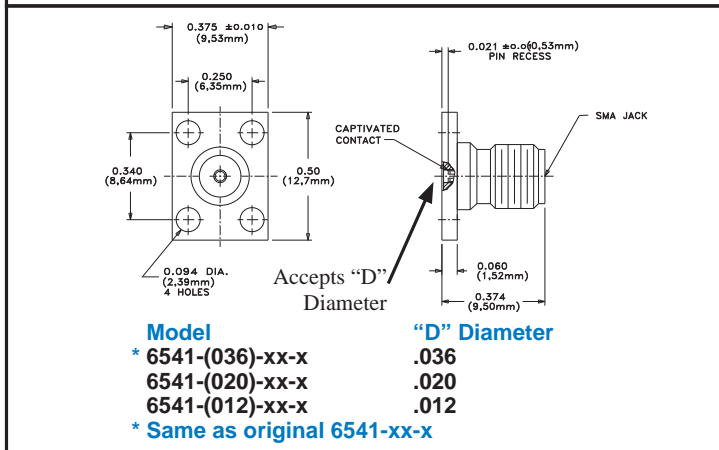
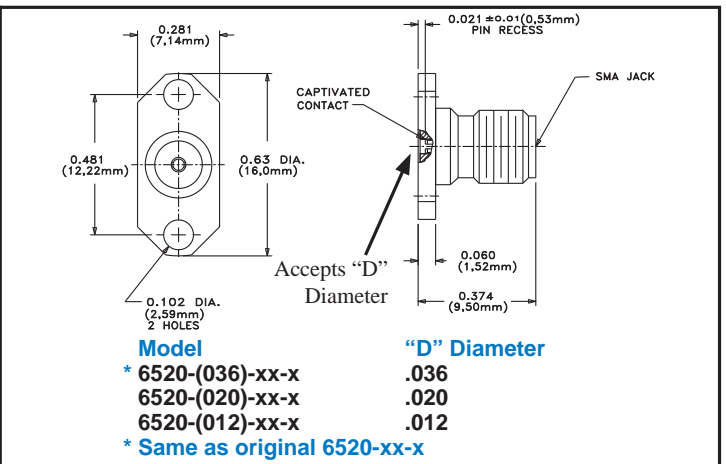
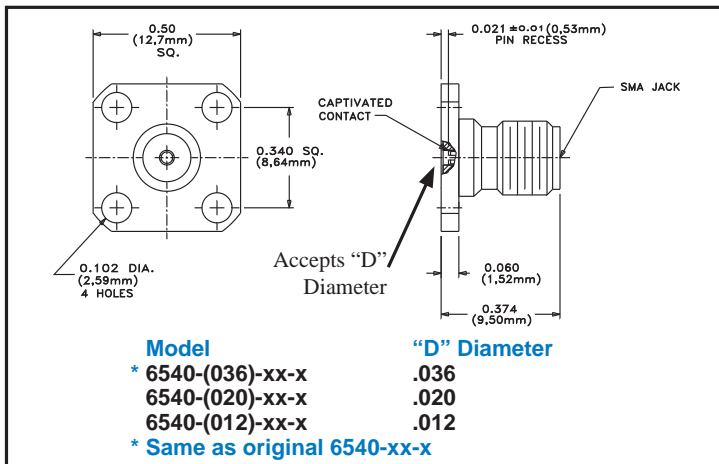
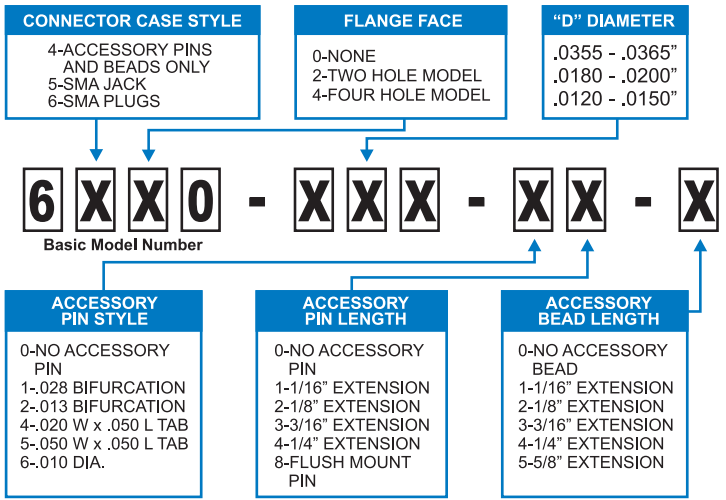

Microwave, RF, and Hybrid Microelectronic Products

www.microlambda.com

info@microlambda.com

E+ PLUS

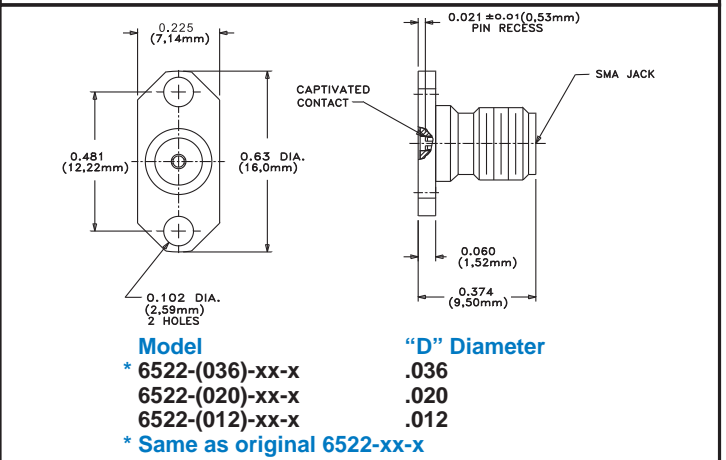

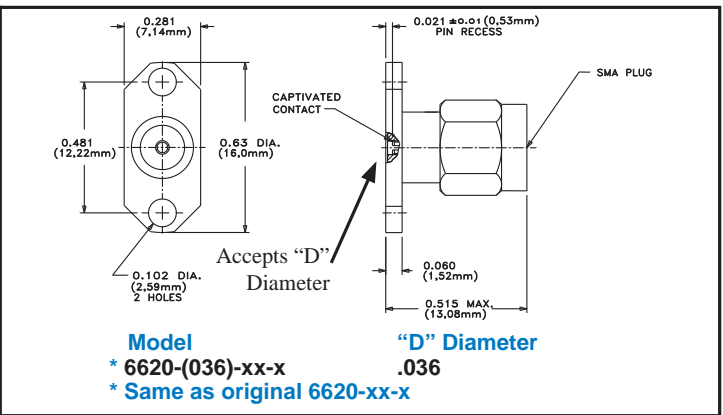
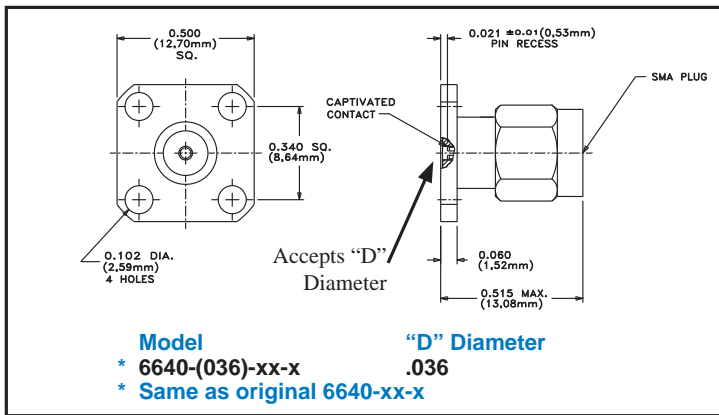

SPECIALS & MODIFICATIONS AVAILABLE UPON REQUEST

Interchangeable Transition Pins

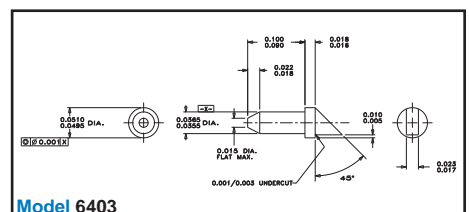
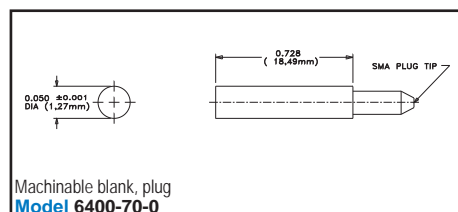
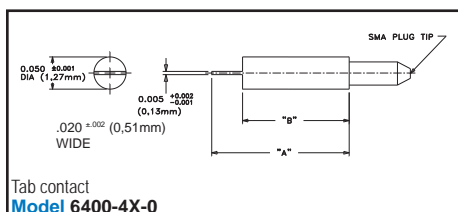
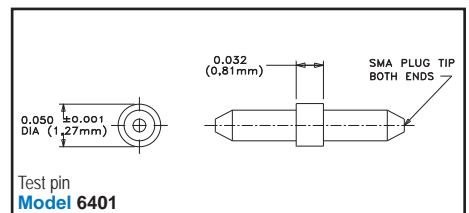
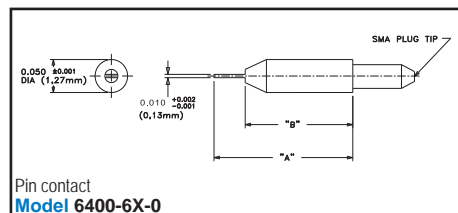
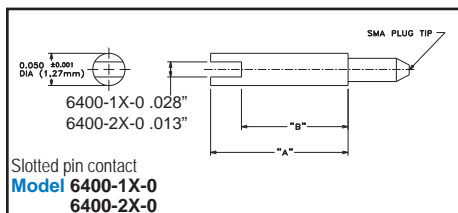
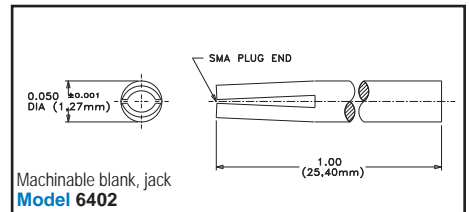
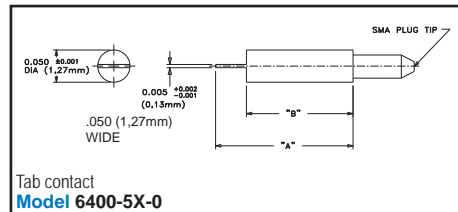
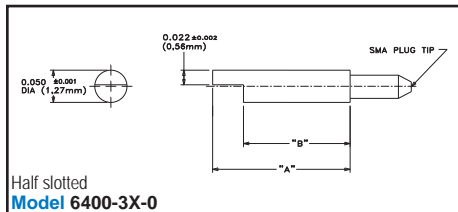

Accessory Pin Lengths

* Accessory Code Position	Package Wall Thickness	"A" Dim.	"B" Dim.
1	1/16"	.136	.080
2	1/8"	.198	.142
3	3/16"	.261	.205
4	1/4"	.323	.267
8	Flush	.073	.017

* Replace "X" with accessory code number to specify length of pin desired

Accessory Beads (PTFE)

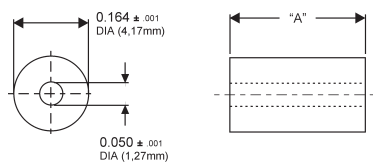

Model #	Circuit Frame Wall Thickness	"A" Dimension (inches)
6400-00-1	0.063 1/16"	0.070
6400-00-2	0.125 1/8"	0.132
6400-00-3	0.187 3/16"	0.195
6400-00-4	0.250 1/4"	0.257
6400-00-5	0.625 5/8"	0.625

Hermetic Seals

Specifications

1. Outer ring & center contact: Kovar; gold/over plated nickel
2. Insulator: Glass
3. Nominal Impedance: 50 Ω
4. Hermeticity: 1 x 10⁻⁸ cc/sec.
5. Unless otherwise specified tolerance is as follows:

FRACTION= +/- 1/32"

0.xx +/- 0.010" • 0.xxx +/- 0.005"

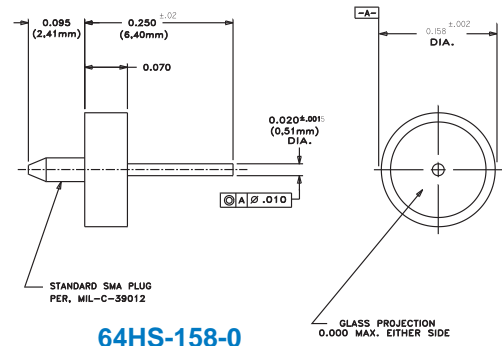
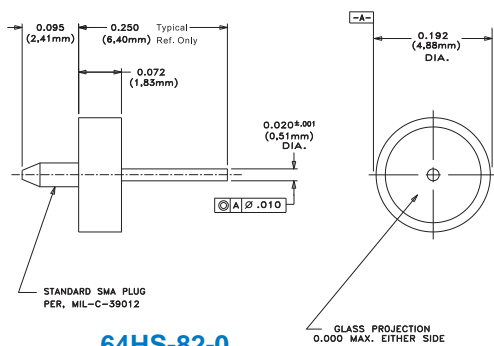

Stocking Distributor for:

EMC Technology, Florida RF Labs Components and our E + Plus SMA Connector product line:

Components:

Temperature Variable Attenuators
Coaxial Terminations
Coaxial Equalizer
CVD Diamond Resistors
CVD Diamond Chip Termination
Chip Attenuators
Couplers
Power Dividers

Flange Terminations
Crossover
Strip line Flange
Flange Terminations
Pill Terminations
Coaxial Remote Terminations
Rod Resistor
Surface Mount Terminations

DC Block
Fixed Attenuators
Power Sensing Terminations
Terminations
Equalizers
Coaxial Attenuators
Coaxial Switch
Directional Couplers

When you do business with Micro Lambda you will benefit from our:

State of the Art Warehouse

Quality Systems/Procedures

MIL- I- 45208 Inspection- ISO 9001-2000 Certificate #08-1027

Technical Support and Representative Heritage

Application Engineers to back up our sales force

Toll Free Technical Hotline 800-952-6232

5000 + Models from stock

Value added kitting

Assembly

Traceability- Lot Coding and Manufacturer

Blanket orders with scheduled deliveries accepted (JIT Delivery)



Microwave, RF, and Hybrid Microelectronic Products

www.microlambda.com

info@microlambda.com

Micro Lambda North

9 Trenton-Lakewood Road • Clarksburg, NJ 08510
Phone: 609-259-0400 • Fax: 609-259-3005

Micro Lambda South

4513 Mountain Road • Pasadena, MD 21122
Phone: 410-437-7633 • Fax: 410-437-9786